

REVISION RECORD				
REV	ECO	DESCRIPTION	DRFT	CHKD

5.DIELECTRIC STRENGTH

NOTES:

MATERIAL :

- 1.HOUSING MATERIAL :GLASS FILLED POLYESTER UL94V-0.
- 2.CONTACT MATERIAL :PHOSPHOR BRONZE $\phi 0.46\text{mm}$.
- 3.PLATING :GOLD PLATING OVER NICKEL.

ELECTRICAL:

- 1.VOLTAGE RATING :125 VAC RMS.
- 2.CURRENT RATING :1.5 AMP.
- 3.CONTACT RESISTANCE :30 MILLIOHMS MAX.
- 4.INSULATION RESISTANCE :500 MEGOHMS MIN @ 500V DC .
- 5.DIELECTRIC WITHSTANDING RESISTANCE :1000V AC RMS 50Hz. 1MIN.

MECHANICAL:

- 1.DURRABILITY :750 CYCLES MIN.
- 2.PCB RETENTION PRE-SOLDER :1 LB MIN.

ENVIRONMENTAL:

- 1. STORAGE : -40 $^{\circ}$ ~+85 $^{\circ}$ C
- 2. OPERATION : 0? TO 70?.

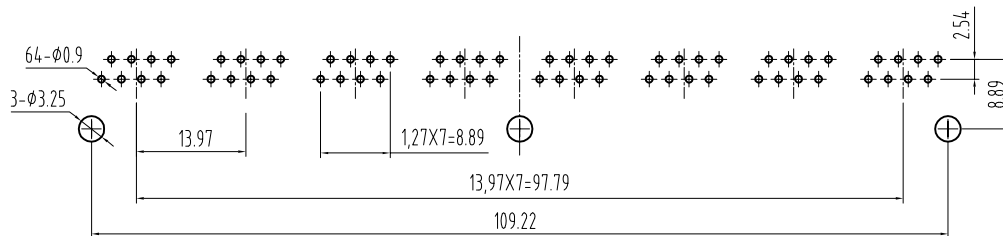
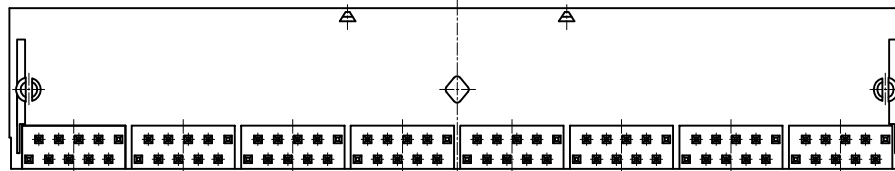
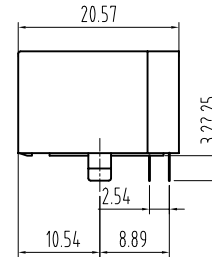
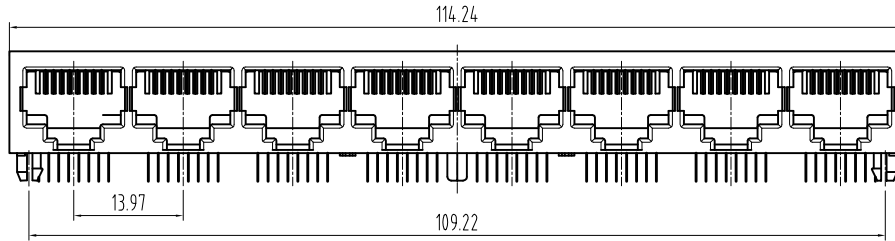

DETACHED LISTS TOLERANCES EXCEPT AS NOTED MM .0 ± 0.15 .00 ± 0.075 .00 ± 0.05 ANGLES ± 0.5 THIRD ANGLE PROJECTION	DFTO: SHB CHKD: LAMB MFO:	DATE: 2007.05.03 DATE: 2007.05.03 DATE:	<h1 style="text-align: center;">Coorle Technology</h1>		
	APPVL: MATERIAL :	DATE: QTY :			TITLE <h2 style="text-align: center;">59A 1x8 JACK W/O SHIELD</h2>
	FINISH :	SCALE :	DRAWING NO. TES9AW11 /PART NO.	SIZE A3	
	DO NOT SCALE DRAWING		SHEET X OF Y		